



January 2021

Supported by



Chelsfield  
Park  
Hospital

ST. MARTIN'S CHURCH, CHELSFIELD

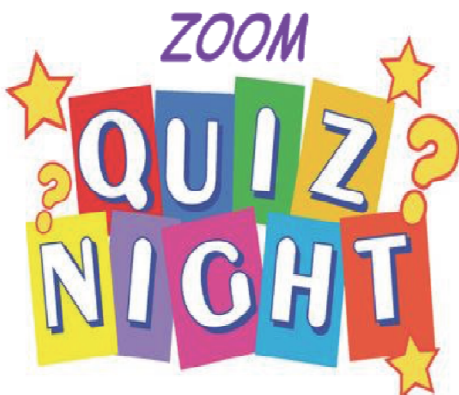

SATURDAY, 16TH JANUARY 2021  
7.30pm

from the comfort of your own home!

Teams - maximum of 6 people \*

Contact: Angela Wilkins at

[oakover2003@yahoo.co.uk](mailto:oakover2003@yahoo.co.uk) to register

\* Can be from different households  
via the wonder of technology

No charge to take part, but a  
voluntary donation would of  
course be much appreciated!  
Scan the QR code to link to  
the donations page. Thank  
you!



Fundraising event for St. Martin of Tours, Chelsfield  
Registered charity: 1131573

The Newsletter and "What's On" Guide for  
Residents & Friends of Chelsfield Village

Nipplewort & Herb Bennett	2
In Memory of Mary Lambert	4
Mutterings from The Millers	4
Walnuts Redevelopment	5
Spreading Christmas Cheer	6
Roundabout Update	6
Unit of Barn Wanted	8
News From St Martin's	8
Downing Street & Chelsfield	9
David is 104 Years Old	12
Village Christmas Tree	12
Painting of St Martin's	12
Take-Aways Delivered	12

Wishing a Happy New Year  
to all residents and friends  
of Chelsfield Village!

Tell us your stories from  
2020 or before  
Share with us your plans for  
2021 and beyond

Submit anything for inclusion in  
the February 2021 issue to:

[chelsfieldvillagevoice  
@gmail.com](mailto:chelsfieldvillagevoice@gmail.com)

or post to:  
Chelsfield Village Voice  
2 Bucks Cross Cottages  
Chelsfield Village  
BR6 7RN

to arrive on or before  
Wed 27th January 2021

## Nipplewort & Herb Bennett

As the autumn has turned to winter I finally plucked up enough courage to venture into my loft to take a look at the wasp nest that has been there all year.



As the summer days pass the wasps can no longer be fed sugar by the pupae in the nest (the wasps feed the pupae insects they have caught and in return the pupae feed wasps a sugar solution as they cannot eat anything more solid). Consequently the wasps begin to starve and this is why they are so persistent at trying to get to your jam sandwiches during your picnic. So, I have not been brave enough to cut the nest out yet as sometimes queens have been known to over-winter in them but I took a photo with a pair of shoes to allow a sense of the size of the nest. For some strange reason

it seems to be spreading across the loft floor. This nest has been built by a yellow jacket wasp and a second nest type can just be seen to the right of the major nest and I have highlighted it with an arrow. A further nest of this type can be seen in the second photo at another location within the loft. It seems that this nest is made by a paper wasp but I have been unable to identify which species. The other possibility is that it is a failed yellow jacket nest. Apparently spiders can and do attack the nest before they become established.



This month I want to talk about a plant, some may say weed, called nipplewort (*Lapsana communis*). I found this in my garden this autumn in an area which is generally left to its own devices and I can usually

find some interesting wild flowers there. This is another of those plants that was historically believed to follow the 'doctrine of signatures'. This is where a plant looks like it is associated with a part of the human body and therefore clearly God has assigned the plant to be used to alleviate ailments associated with that part of the body. In the case of nipplewort the closed flower buds appear to be nipple-like (although rather small) and so the associated body part is obviously nipples. Sore or lacerated nipples would be treated with this plant and in the 16 century Prussian apothecaries called it papillaris from the Latin word papilla, or 'teat'. The French and German equivalents of the common English name are Herbe aux Mamelles, and Niplewurz.

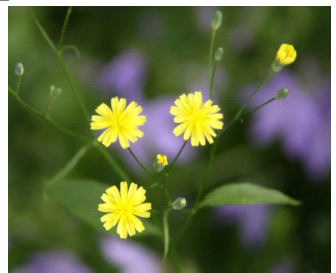

It's a rather spindly plant that is generally inconspicuous and can grow to a height of about three foot albeit with more substantial leaves on the lower parts. It has small yellow flowers which close up in the afternoon and in poor weather, may not even open. It is one of those plants that appear familiar to most but very few can identify it despite the clue in its name. After pollination, the petals fall away and the seeds ripen. Some individual nipplewort plants can produce 1,000 seeds so it has potential as a problem weed if found in the wrong place. Unlike dandelion seeds however, these seeds are not equipped with airy plumes to transport them away on the wind. Instead they rattle in their drying cases and don't fall far from the parent plant. During winter, the distinctive brown, brittle remains stand evident of the past summer season with the seeds gone. Nipplewort can be eaten in salads and be treated like lettuce despite its mild bitterness and chewy foliage. You can eat the leaves or upper stem portions raw or prepare them however

you prefer your greens. Medicinally it does not seem to have any benefits so the 'doctrine of signatures' seems to have failed its own acid test.



Another plant I found in the same patch of ground is Herb Bennet (*Geum urbanum*), also known as wood avens. This is similar in appearance to nipplewort with small yellow flowers although herb bennet has only five petals and it's structure is less spindly. It also has small petal covers that retract to expose the petals and appear as little spikes between the petals.

It seems to have been a useful plant in historic times and was considered one of the most powerful charms against evil

spirits. According to an early medical journal from 1491, "if a man carries the root about with him, no venomous beast can touch him". Interestingly it was also used to treat poison – presumably not delivered by a venomous beast! It derived these miraculous abilities from an association with St Benedict (Bennet) because it has leaves in groups of three and petals in groups of five: reminiscent of the Holy Trinity and the 'Five Wounds'.

The roots smell of cloves and have many uses. They could be used as both fly repellent and as a source of flavour in beer, soups and stews and even to shroud the smell of body odour in the days when washing was considered posh. Nowadays, they are more likely to be added to stews and apparently they can be fried when they puff up to look like calamari.

Here's hoping for a better 2021 than 2020.

*Steve Fuller  
January 2021*

## In Loving Memory of Mary Lambert

It was heartbreaking to hear that on Wednesday 23rd December Mary Lambert had peacefully passed away at her home following a serious illness she'd endured since June.

Our deepest and sincere condolences go to Dave, her husband, their children, Caroline, Howard

and Vicki, and their seven grandchildren.

Mary was a very much loved resident of Chelsfield Village who along with Dave always enjoyed and supported local events and initiatives.

She was a very warm and kindly person, always able

to brighten your day with a friendly smile or laugh.

Mary, you are, of course, going to be greatly missed by your family and friends, but will also be a huge loss to the community of Chelsfield Village as a whole.

**Rest in Peace**

## Mutterings From The Millers

### Happy New Year to you all!

Some of you may have passed the farm and noticed that "Bertie" has returned. We felt that we



all needed cheering up so Peter and Steve rebuilt him.

The chickens were rehoused in the greenhouse on the 14th December following government rules on the avian flu. With the windows and door open and covered with mesh to stop wild birds entering, they seem quite happy in there. At least they keep dry.

December was another wet month with 120 mms of rain which as can you an imagine has made the ground very wet, so nothing has been done in the fields.

The trees from the farm to the main road are quite large now and are in need of urgent attention but it is so dangerous trying to work on them. With the forthcoming roadworks for the new roundabout, we hope that our part of the road will be closed and

then the boys can work on them safety.

The famous lines of John Keats reflect the fact that St. Agnes Eve, 20th January, is reputedly the coldest day of the year in southern Britain. St. Hilary's Day, 12th January, has the same reputation in the north.

*St Agnes Day, ah bitter chill it was*

*The owl for all his feathers was so cold*

*The hare limped trembling through the frozen grass*

*And silent stood the sheep in dusky fold.*

Chris Miller  
Court Lodge Farm



## Walnuts Shopping Centre Redevelopment Plans

Tikehau Capital acquired the Walnuts Shopping Centre in 2019, and Areli Real Estate is now leading the project on behalf of the owners.

Earlier this year, Areli invited local residents and businesses to define their problems and solutions for Orpington town centre. This has now become an 81 page public consultation document.

It was brought to my attention that there was an “exhibition” - which was not easy to find. It consisted of a few boards hidden behind the café in the open area outside Wilko’s.

In this initial proposal it mentions 900 units spread between four storey buildings at the edges, a number of 12 storey high (the same as Orpington College, and one block 24 storeys high.

I know this is just an initial plan, but does appear to be totally out

of scale in height and density to the rest of Orpington. It does not appear that a planning application has yet been submitted.

More information, plans

and artists impressions is available at: [www.thewalnutsorpington.co.uk](http://www.thewalnutsorpington.co.uk)

*Our thanks to Christine Hellicar for bringing this to our attention*

### MASTERPLAN

**KEY BENEFITS**

- Open streets for thriving local and independent businesses
- High quality public realm with a revitalised town square
- Creating strong links into the High Street
- Connecting communities and green spaces to Orpington town centre
- Providing new homes in the heart of Orpington and protecting the Greenwell
- Increasing footfall and creating a new Landmark
- Creating a vibrant and sustainable town centre

**THE WALNUTS SHOPPING CENTRE**  
December 2020

### VISION

This is a once in a generation opportunity to create a beautiful, vibrant and sustainable town centre destination for Orpington and its communities.

**Core principles**

- Supporting jobs and long-term viability of the High Street
- Enhanced public facilities for the existing community
- Enhancing Orpington's night time economy
- Supporting homes for the younger next generation
- Supporting Orpington's 'Major Town Centre' status
- No decisions have been taken as to whether the Saxon Day Centre is to be included as part of the overall proposals. The scheme can leave it in situ if that is the decision of the Council.

**THE WALNUTS SHOPPING CENTRE**  
December 2020

## Spreading Some Christmas Cheer

A huge thank you to everyone who supported the Chelsfield Volunteers' Christmas hampers. You helped bring some much needed cheer to local households who have had a tough year through illness or bereavement, or who are just struggling to manage this Christmas.



We thought we might send out a dozen hampers, but owing to the generosity of those who gave, and the hard work of the volunteers, we managed forty nine!

One hamper went to an 89 year old very frail lady in Chelsfield. Her

daughter was delighted with this support for her mum and has messaged to say "thank you all for all your hard work, you have all made a difference in this world, God bless you all and keep you safe".

**If you are self isolating or shielding and need**

**help with shopping or prescriptions please leave a message with our helpline 07767 211891.** We can also help if you are feeling isolated and would just like to have someone to talk to. Find us on Facebook at Chelsfield Volunteers Covid-19 Mutual Aid Group.

## Roundabout Update

Rineys will be starting junction improvement works at the Court Road / Warren Road junction in January 2021.

Temporary traffic signals will be in place from Monday 11/01/2021 for up to four months. I've requested for these lights

to be manually operated during peak traffic times.

Warren Road will be closed on the Chelsfield Village side of the works at the junction of Court Road. Signed traffic diversions will be in place for motorists wanting to enter Chelsfield Village.



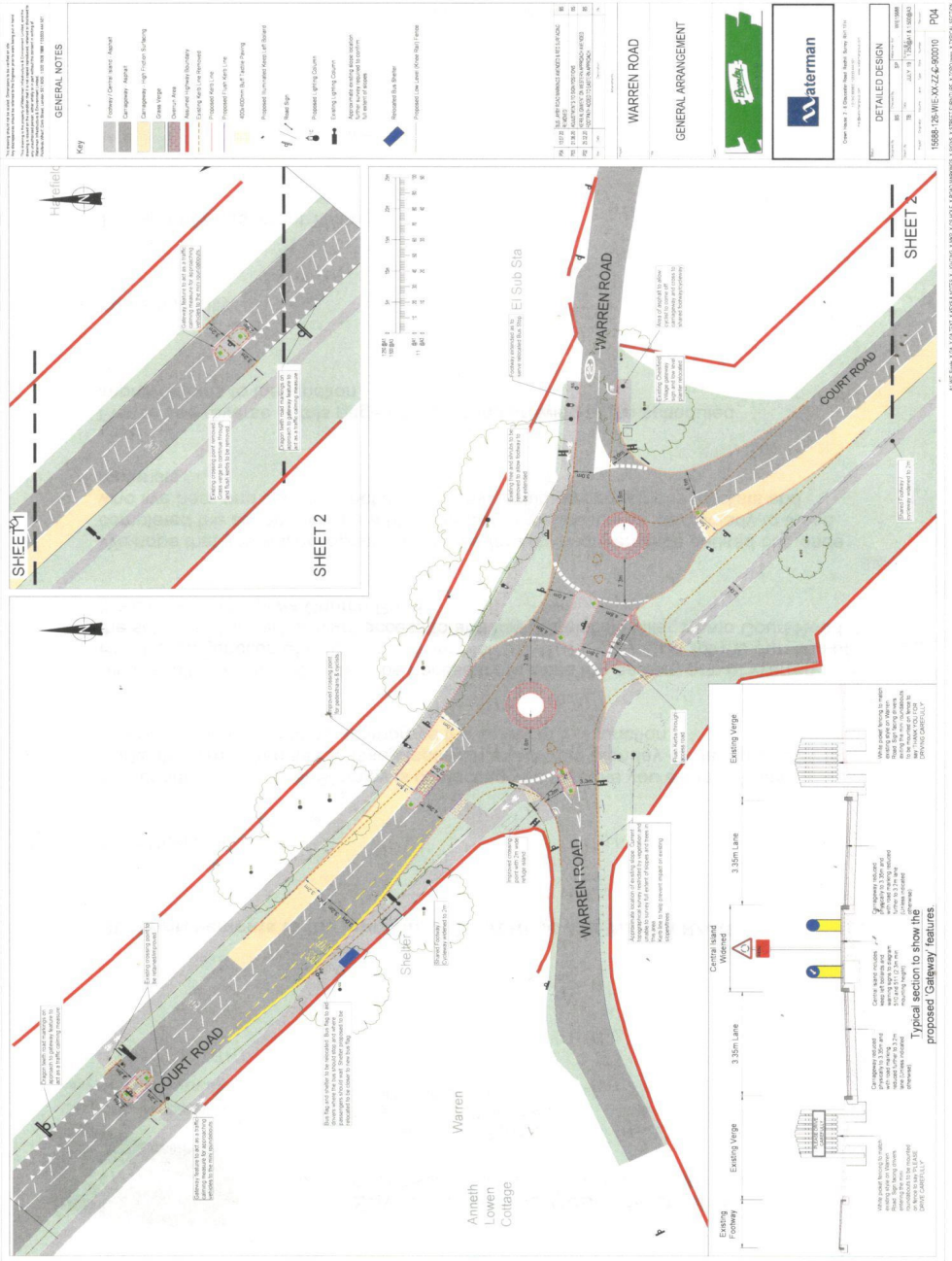

**GENERAL NOTES**

167	Proposed Central Island	Proposed Central Island
168	Proposed Central Island	Proposed Central Island
169	Proposed Central Island	Proposed Central Island
170	Proposed Central Island	Proposed Central Island
171	Proposed Central Island	Proposed Central Island
172	Proposed Central Island	Proposed Central Island
173	Proposed Central Island	Proposed Central Island
174	Proposed Central Island	Proposed Central Island
175	Proposed Central Island	Proposed Central Island
176	Proposed Central Island	Proposed Central Island
177	Proposed Central Island	Proposed Central Island
178	Proposed Central Island	Proposed Central Island
179	Proposed Central Island	Proposed Central Island
180	Proposed Central Island	Proposed Central Island

**WARREN ROAD**

**GENERAL ARRANGEMENT**

**Waterman**

**DETAILED DESIGN**

1588-15-WE-XX-22-00010 P04

© 2021 Waterman. All rights reserved. This document is the property of Waterman. No part of this document may be reproduced without the prior written permission of Waterman.



## Small Unit or Barn Wanted to Rent

Small unit / barn (approx. 600 sq.ft.) wanted to rent for non-business purposes in Chelsfield or surrounding areas. Please contact Adam on: 07812068641

## News From St Martin's - Your Parish Church



*St Martin's worships and serves a loving God,  
reaching out to the community in the name of Jesus Christ*



Although we are in Tier 4, at the time of writing the regulations allow churches to hold services so we will be open as follows:

### St Martin's

Sun 3 Jan	10.00am	Family Communion (Epiphany)
Wed 6 Jan	9.30am	Holy Communion (BCP)
Sun 10 Jan	10.00am	Family Worship (First Sunday of Epiphany, Baptism of Christ)
Wed 13 Jan	9.30am	Holy Communion (BCP)
Sun 17 Jan	10.00am	Family Communion (Second Sunday of Epiphany)
<i>18-25 January - Week of Prayer for Christian Unity</i>		
Wed 20 Jan	9.30am	Holy Communion (BCP)
Sun 24 Jan	10.00am	Family Worship – led by Ken l'Anson (Third Sunday of Epiphany)
Wed 27 Jan	9.30am	Holy Communion (BCP)
Sun 31 Jan	10.00am	Family Communion (Candlemas)
	6.30pm	Holy Communion (BCP)

### Well Hill

Sun 24 Jan 10.00am Holy Communion\*

\* Services at Well Hill are weather-dependent and have limited capacity – for more information please contact Anne Ireland on 07767 783189 / anneireland@icloud.com

As this is still a changing situation it's important that we look out for one another. Please let Rev John know of anyone who is ill or in distress, or if you need prayer or spiritual support, or are lonely and just need a short chat please phone 01689 825749.

For more information on St Martin's please visit our website and Facebook page, or search for @ChelsfieldStMartins on Twitter and Instagram

[www.stmartinchelsfield.org.uk](http://www.stmartinchelsfield.org.uk)



Like



View



Follow



Watch



## From Downing Street & Chelsfield Part 2

Last month I wrote about my 4 x Great Uncle Frederick Gough who started his working life as a messenger in the Colonial office and finished his career as the Resident Superintendent of that organisation. In 1907 he died of a heart attack: his certificate showing that he was living in Downing Street at the time. In his will he left over £1600 to somebody called Richard Gough Cornfold. His middle name showing that he was clearly a relative of some sort to Frederick but one I was unaware of. So I decided to investigate.

To my surprise I found that he had been born in Chelsfield in 1869! So, I looked at the 1871 census return and found he was recorded as living at Bucks Cross Cottages as a 'Nurse Child' along with a family by the name of Hills. This name refers to a child that does not belong to a family but is being nursed, or bought up by that family. Close by at another address and also described as Bucks Cross Cottages were a family with the

same 'Cornford' surname as Richard but without a mother/wife showing on the census. The 'head of house' however was called Jonathon who was described as a widower. Clearly Richard had been 'farmed out' to a family that could look after him while his father Jonathon attended to work. The other children were also either working or too young to be given the responsibility of raising a young child and/or attend school. A search for births and deaths of the individuals on the census showed that life for this family had been difficult and the following story unfolded.



As the census shows, the head of the family was Jonathon Cornford. Further research showed he had been born on the north Kent coast and had married somebody called Amelia Potts and had moved to Chelsfield in the mid 1850s. He worked as a Farm Bailiff, as his father had before him and presumably had moved to the village for work which I assume had been at Bucks Cross Farm. I have tried to use the census returns to find out exactly where Jonathon lived using both the 1871 census and those taken before and after, but this is not always easy as census returns at this time rarely give exact addresses in village settings.

There are various interpretations of the census data and despite looking at three decades of census returns there is some room for doubt as to exactly where the Cornford family lived. However, I am pretty confident that they lived at the bottom of Maypole Road (my own road) either at Bucks Cross farm or rather

unbelievably, in Dan and Avis Sloan's cottage! One can follow the Bucks Cross Cottages in the 1871 census as they are recorded by the enumerator as he moves away from the centre of the village and this shows that the Cornford family are living in the last dwelling before Mount Hall on Maypole Rd. Unless the enumerator has taken a very strange route while recording the data, that would mean that my 4 x Gt Aunt and Uncle lived in the cottage that Dan Sloan, our esteemed 'Village Voice' editor currently lives in or at Bucks Cross Farm! Coincidence or what! See photo of Dan's cottage in earlier times. Note that even until quite recent times the entrance to the property was right on the junction of Maypole Rd and Hawstead Lane and this is shown in the photo although it only allows access to a path. The feathered curb even now shows that this was at one time an entrance for vehicles.

So, lets back up and reconstruct the history of the Cornford family during their time in Chelsfield. As mentioned, Jonathon and Amelia were not natives of

Chelsfield but moved here in the 1850s and had 5 children most of whom were born in the village. Amelia then appears to have died in 1866 due to blood loss associated with a fractured arm. Her place of death is recorded as Orpington and no family member was present at the death. This may have been some sort of tragic accident but it is difficult to be certain. Strangely she is not even recorded as having been buried at Chelsfield Church so maybe there's a deeper story there that will never be known. After his wife's death Jonathon somehow met and married my 4 X Great Aunt Charlotte Gough who, although born in Berkshire had a few years earlier been working as a servant in Marylebone, London. This marriage happened a year after Amelia's death and in March 1869 Charlotte gave birth to her first and only child Richard Gough Cornford, my first cousin 4 times removed. Note that he had been given Charlotte's maiden name 'Gough' as his middle name. Shortly after Richard's birth, on the 12<sup>th</sup> April, his mother Charlotte dies. I originally assumed her death was related to the birth of Richard but it

seems that Bronchitis was the cause which according to her death certificate she had been suffering from for 4 weeks, i.e. it began immediately after Richard's birth.

Just two years later the 1871 census is taken and this shows that Jonathon is living with his four children: David, Jonathon, Henry and Mary. They do have another, older



brother William, but he is working for William Waring in the building which is now the BMI Hospital as a footman (often considered as the role of trainee butler) and was absent from the family home on the night of the census. Unfortunately miss-fortune strikes again and young Henry, aged 13 dies of scarlet fever and diphtheria a short two months after the census was taken. Diphtheria is now an almost forgotten disease but in the late 19<sup>th</sup>

century it was a major killer which affected everybody from members of the Royal family to the poorest. It was a bacterial infection that was known as 'The strangling disease' and affected children more frequently than adults. It caused a thick film to develop in the throat making breathing increasingly difficult. Such is the family's misfortune that tragedy strikes yet again and just a week after Henry's death the head of the household Jonathon dies of the same combination of diseases – presumably contracted from Henry. Although serious, prior to the introduction of antibiotics, diphtheria rarely killed more than about 10% of its victims so it was particularly unfortunate that two members of the family should lose their lives in this manner. In these days of modern medicine we tend to forget that raising a family in Victorian Britain was something of a lottery with the odds stacked against you.

All of the three Cornford deaths are recorded in the Chelsfield church records although there does not appear to be a gravestone associated with any of

them. So, the family now consists of four siblings and their baby half-brother Richard. The oldest sibling William, is 20 with two other boys working as labourers. The combined income was probably not enough to pay for the rent or maybe the cottage accommodation was tied to Jonathon's job as a bailiff. Either way the family seems to have split up and moved away from Chelsfield. Most appear to have married including Mary the youngest who seems to have married in her father's home village of Tunstall in Kent which suggests she may have been fostered out to relatives still living there. The same happened to my distant cousin Richard who appears in 1881 as a twelve year old living with my distant Great Uncle Frederick Gough who I wrote about last month and is mentioned at the start of this piece. Richard is using his middle name Gough rather than his birth name Cornford (but re-assumes the name Cornford in later life). This individual is of the right age and was born in Chelsfield and there is no sign of Frederick and Elizabeth having children in the previous census so

I am happy this is one and the same person. So, what happened to Richard? Well, in 1902 he was a Captain in the East Surrey 4<sup>th</sup> Volunteer Battalion and looks the part in the attached photo – Victorian Empire builder or what! This appears to be a part time 'voluntary' position as most of his career appears to have been spent in the more sedate role of a bank clerk.

So, what started as an interesting link between one of my distant family members who had a responsible administrative position within the Colonial Office in Downing Street ends with a tail of tragedy in Chelsfield village which in a strange quirk of fate may well be linked to Dan Sloan's cottage. In all, there was one wedding, one birth and three deaths associated with the Cornford family in a short five year period and this all happened just down the lane from where I live.

Thanks to Philippa Rooke for help with Chelsfield Church records and Dan Sloan for the use of his photograph.

## Congratulations David Lane 104 Years!



David Lane celebrating his 104th birthday, at his home in Chelsfield Lane, on Christmas Eve 2020. Sadly he was limited to only his carers and son

Philip as visitors as Tier 4 a house for hedgehogs prevailed. as well as new padded laptrays.

Plenty of hooch, sweets, a handmade birdbox and

*Philip Lane*

## Village Christmas Tree

Following on from Sofia's clever idea for the village to decorate the Christmas Tree, we can announced that it was a great success with a whole host of varied contributions! Surely this must become a new Chelsfield Village tradition? So be ready for Christmas 2021!



## Local Painting

Similar to others, during these times of lockdown, we were sorting through our children's possessions, left behind when they moved to their own homes. We found our son's art work that he presented for his GCSE Art.

Leslie Virgo was thrilled to see this painting of his church. So, we thought we would share it with you all and the fact that 17 years later our son is a successful architect.

*Karen and Christopher Martin.*



## Take-Away

Sadly, now Tier 4 has been imposed on this area we are again restricted to our homes with all the pubs, restaurants and non-essential shops closed.

However, if you are completely fed up with cooking and desperate for the easy life it is worth noting that "Just Eat" and "Uber Eats" both deliver to the village. We are still out of range for "Deliveroo".